



Level 3/320/32 Bray Street South Yarra VIC

2 1 1

In the heart of Chapel Street precinct & all it offers.

Situated on the 3rd floor with City Views.

Apartment comprises: Security swipe entrance, functional kitchen with gas cooking, electric oven and dishwasher, large open plan living with split system air con and access to balcony. Two good sized bedrooms with mirrored panel built in robes, separate bathroom and European laundry.

Building offers: On-site building manager, roof top terrace with outdoor spa, and city views. Indoor lounge/dining facilities and gym.

Secured basement car space & above bonnet storage

Type : Apartment

View : <https://www.mooreco.com.au/lease/vic/inner-city/south-yarra/residential/apartment/8148080>

[For full version visit the website](https://www.mooreco.com.au)

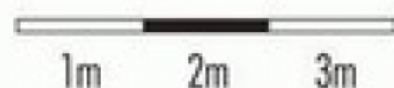
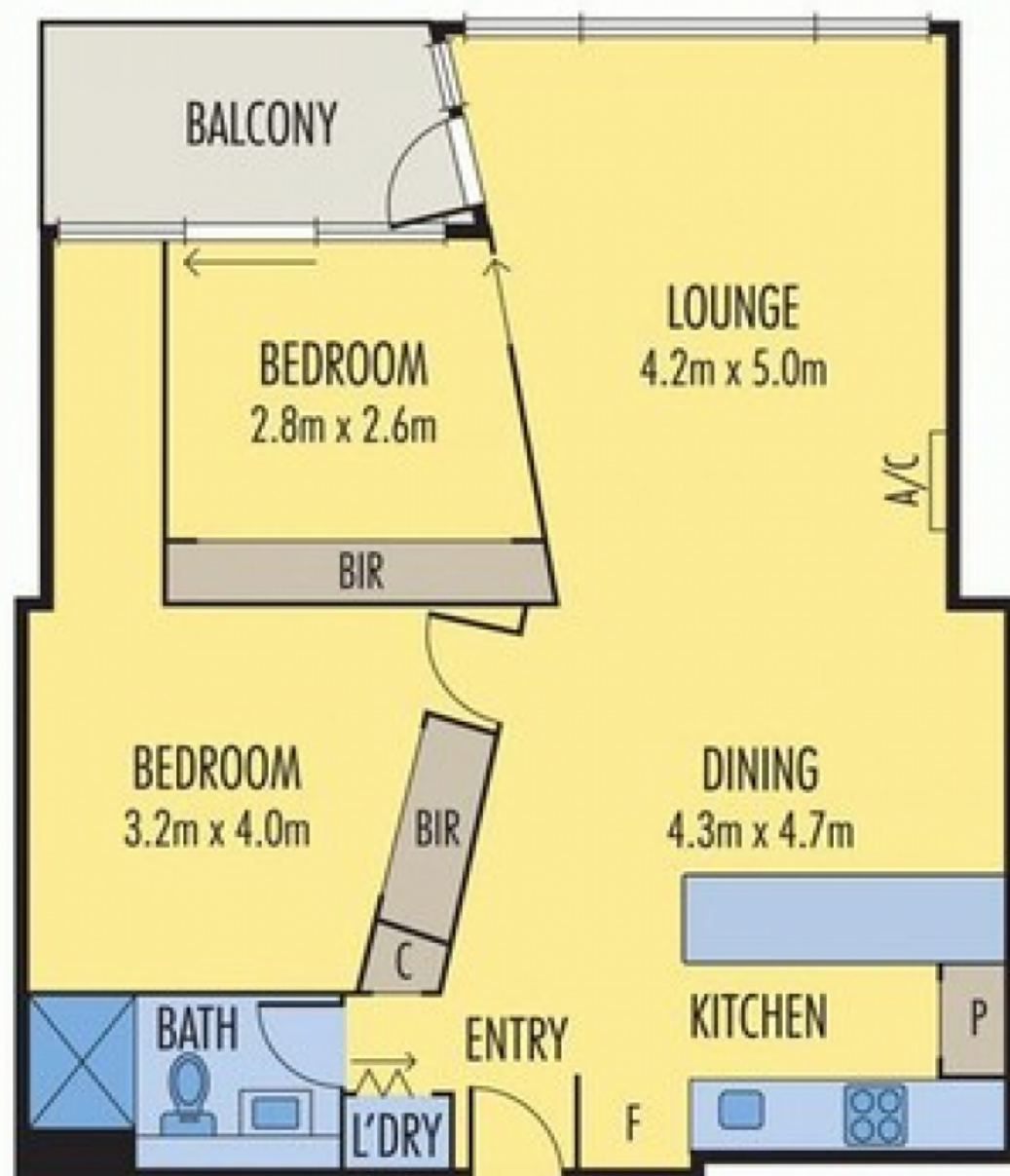

STORE

CARSPACE
(NOT IN POSITION)